



# INSTALLATION, OPERATION AND MAINTENANCE INSTRUCTIONS

## LEINS3 SERIES LED LIGHTING FIXTURES

### IMPORTANT SAFEGUARDS READ AND FOLLOW ALL SAFETY INSTRUCTIONS BEFORE INSTALLING THIS FIXTURE

- This fixture should be installed by qualified technicians in strict accordance with the National Electrical Code and any local requirements.
- For non-adjustable cord and plug application, the fixture should be mounted directly below the outlet/busway, in accordance with NEC 410.62(c)
- For cord equipped application without an attachment plug, suitable strain relief for the gauge and number of conductors must be used.
- To maximize longevity of the fixture, do not mount near heat sources.
- The use of accessory equipment not recommended by the manufacturer may cause an unsafe condition and/or void warranty.
- This fixture is designed for general lighting purposes. Do not use fixture for other than intended use.

### SAVE THESE INSTRUCTIONS

#### INSTALLATION NOTES

1. To prevent the risk of electrical shock, deactivate/disconnect the power supply before installing or servicing this fixture.
2. Before installing, check the fixture label to ensure correct voltage and frequency.
3. Refer to the following pages for typical fixture mounting. Mounting hardware is not supplied.

#### MAINTENANCE DATA

Although no routine maintenance is required to keep this fixture functional, it should be checked periodically to ensure that it is functioning properly, and to inspect for external damage.

For optimal performance and longevity, keep the light transmission lens clean. Refer to the following guide for recommended cleaning methods.

- Glass care: Rinse the lens with warm water and clean with a mild soap solution or commercially available glass cleaner and a lint free cloth; rinse well. To remove grease, oil and graffiti, use Isopropyl Alcohol or kerosene followed by the above soap solution sequence. Avoid cleaning the lens in direct sunlight.
- Acrylic care: Rinse the lens with warm water and clean with a mild soap solution or commercially available plastic cleaner and a lint free cloth; rinse well. Avoid cleaners that contain ammonia or alcohol. To remove grease, oil and graffiti, use Hexane or kerosene followed by the above soap solution sequence. Avoid cleaning the lens in direct sunlight.
- Polycarbonate care: Rinse the lens with warm water and clean with a mild soap solution or commercially available plastic cleaner and a lint free cloth; rinse well. To remove grease, oil and graffiti, use Isopropyl Alcohol or kerosene followed by the above soap solution sequence. Avoid cleaning the lens in direct sunlight.

In the event of lens breakage, it will be necessary to replace the entire lens assembly. Contact the factory for replacement details.

## OVERVIEW

### MODEL # IDENTIFICATION

Number of Rows	Length of Fixture				
	2 ft	4 ft	6 ft	8 ft	
	1 row	LEINS3-P_-2-1	LEINS3-P_-4-1	LEINS3-P_-6-1	LEINS3-P_-8-1
	2 row	LEINS3-P_-2-2	LEINS3-P_-4-2	LEINS3-P_-6-2	LEINS3-P_-8-2
	3 row	LEINS3-P_-2-3	LEINS3-P_-4-3	LEINS3-P_-6-3	LEINS3-P_-8-3
	4 row	LEINS3-P_-2-4	LEINS3-P_-4-4	LEINS3-P_-6-4	N/A

## LEINS3 SERIES DIMENSIONS

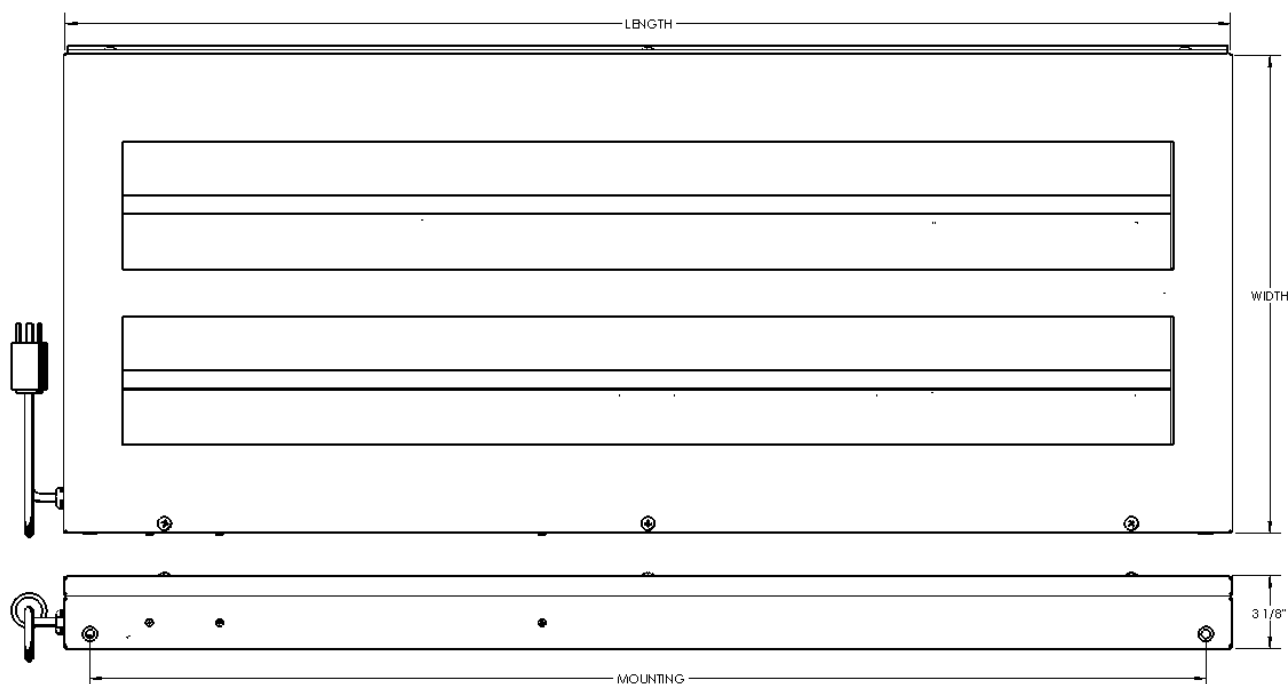

		Length of Fixture				
		2ft	4 ft	6 ft	8 ft	
Number of Rows	1 row	Length	28"	50"	72"	94"
		LEINS3 Width	10"	10"	10"	10"
		Mounting	23 3/4"	47 3/4"	70"	70"
	2 row	Length	28"	50"	72"	94"
		LEINS3 Width	17 1/2"	17 1/2"	17 1/2"	17 1/2"
		LEINS3W Width	20 1/2"	20 1/2"	20 1/2"	20 1/2"
		Mounting	23 3/4"	47 3/4"	70"	70"
	3 row	Length	28"	50"	72"	94"
		LEINS3 Width	25"	25"	25"	25"
		Mounting	23 3/4"	47 3/4"	70"	70"
	4 row	Length	28"	50"	72"	N/A
		Width	32.5"	32.5"	32.5"	N/A
Mounting		23 3/4"	47 3/4"	70"	N/A	

## TYPICAL MOUNTING

STATIONARY MOUNTING KIT  
PART NUMBER: 10315

HINGED MOUNTING KIT  
PART NUMBER: 10314

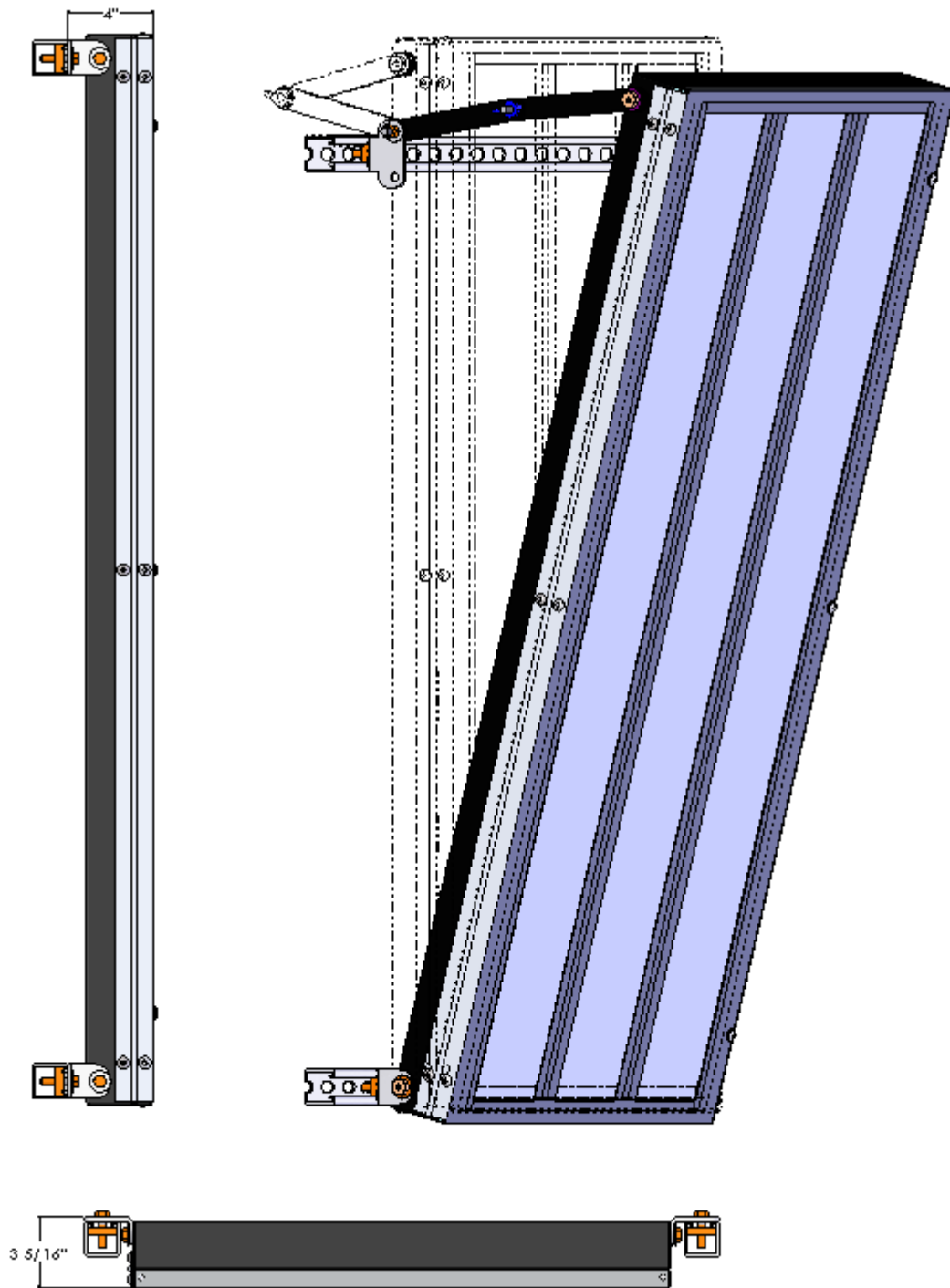

LOW PROFILE STATIONARY MOUNTING KIT  
PART NUMBER: 10387

## **TYPICAL WIRING/ROW**

### **2 FOOT FIXTURE**

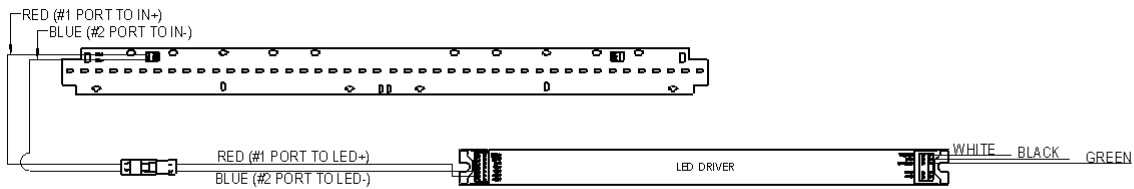

### **4 FOOT FIXTURE**

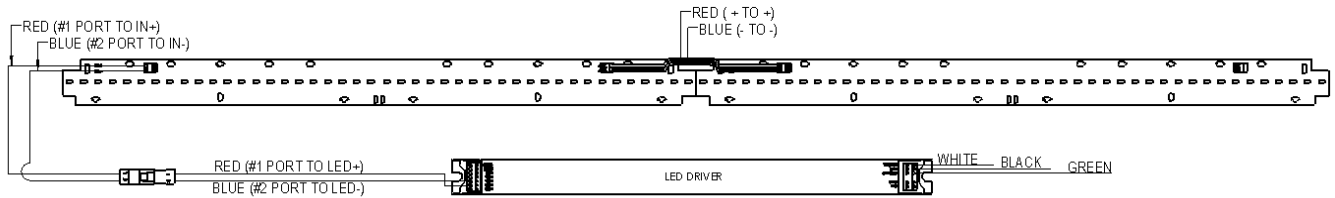

### **6 FOOT FIXTURE**

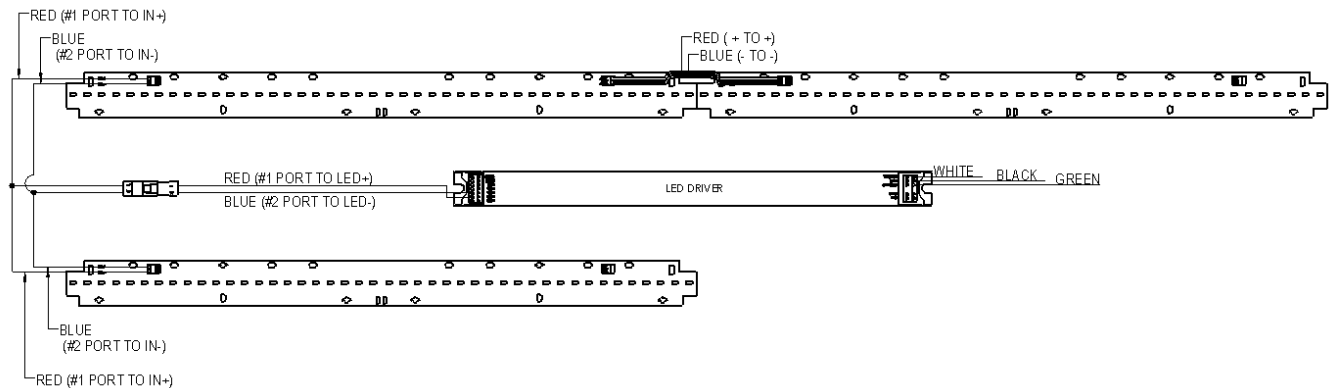

### **8 FOOT FIXTURE**

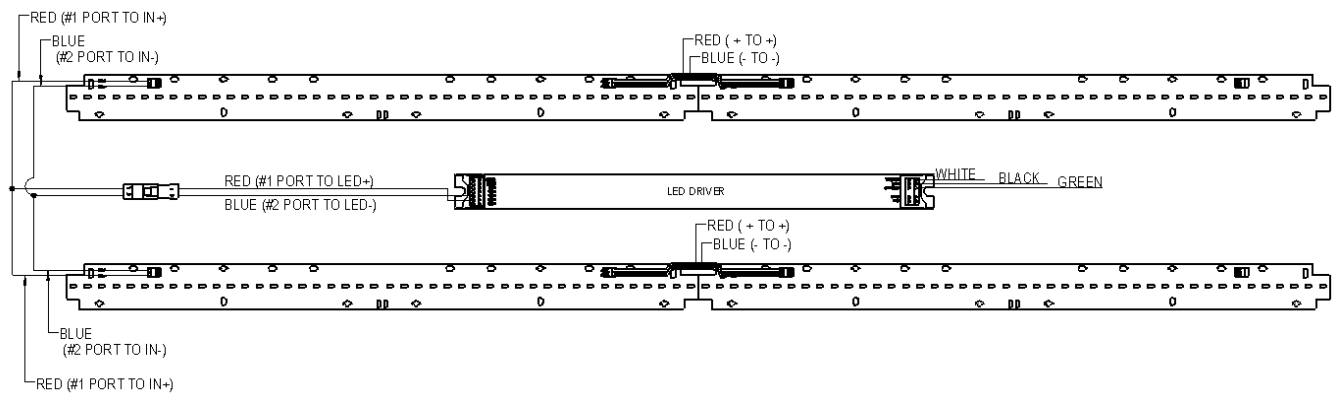

## LED Module Access/Replacement:

1. Deactivate/disconnect the power supply from the supply circuit.
2. Remove/loosen the access fasteners for the lens and reflector assembly as shown in figure 1.
3. Disconnect the led module electrical disconnect shown in Figure 1.
4. Remove the module assembly access fasteners on each end of the module and gently remove the module assembly from the fixture ( If replacing the LED board proceed to step ; If replacing the entire module assembly, follow the steps above in reverse order for re assembly).
5. Remove the optic ( if applicable). With the module assembly on a flat surface, use your thumb and middle finger to lift up on the optic release tabs at the end of the optic.
6. Remove the LED board. (To prevent damage from electrical static discharge, it is highly recommended that the technician and work area be properly grounded). Using a fine tipped instrument, press the wire release tabs shown in figure 3 and remove the wires.
7. Remove the LED module fasteners.
8. Replace the LED board. Place the new LED board in the same location and orientation as the previous board and secure in place with the LED module fasteners. Use caution not to apply too much pressure on the LED module. The LED module fasteners only need to hold the board flat against the mating surface.
9. Follow the above steps in reverse order for reassembly.

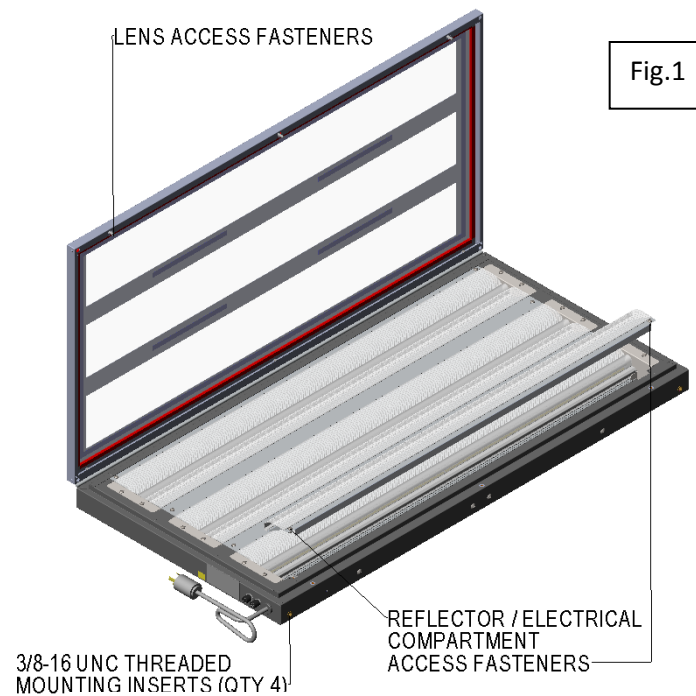

Fig.1

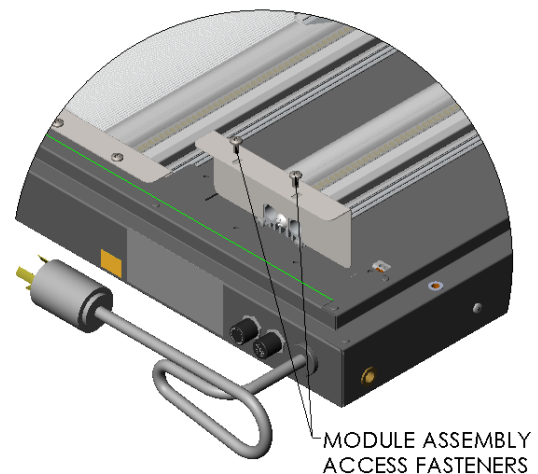

Fig.2

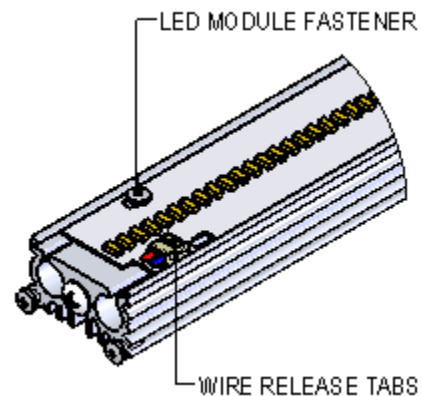

Fig.3



# INSTALLATION INSTRUCTIONS

## INSPECTION FIXTURE PIVOT MOUNT KIT P/N 10314

FOR USE WITH LEINS3, INS3, 39042LINS AND 39082LINS SERIES FIXTURES

### WARNING!

1. THESE INSTALLATION INSTRUCTIONS COVER THE ASSEMBLY OF THE MOUNTING KIT ONLY. FOR INSTALLATION AND WIRING OF THE LIGHT FIXTURE PLEASE REFER TO THE INSTALLATION INSTRUCTIONS FOR THAT PARTICULAR LIGHT FIXTURE.
2. IT IS THE CUSTOMERS RESPONSIBILITY TO INSURE THAT THE STRUCTURE THIS MOUNTING KIT IS ATTACHED TO IS CAPABLE OF SUPPORTING THE WEIGHT OF THE LIGHT FIXTURE THAT IT IS BEING USED TO MOUNT. CONSULT THE LDPI SPECIFICATION SHEET FOR THE WEIGHT OF YOUR PARTICULAR FIXTURE.
3. THESE INSTALLATION INSTRUCTIONS SHOW HOW THE MOUNTING KIT CAN BE ATTACHED TO A UNI-STRUT STRUCTURE. IF THE KIT IS MOUNTED TO A DIFFERENT TYPE OF STRUCTURE OR SURFACE IT IS THE CUSTOMERS RESPONSIBILITY TO SELECT AND USE THE APPROPRIATE TYPE OF MOUNTING HARDWARE FOR THEIR APPLICATION.
4. THIS FIXTURE SHOULD BE INSTALLED BY QUALIFIED TECHNICIANS IN STRICT ACCORDANCE WITH THE NATIONAL ELECTRICAL CODE AND ANY LOCAL REQUIREMENTS.

### PIVOT MOUNT KITS COME PARTIALLY ASSEMBLED

#### EACH KIT INCLUDES:

- (2) HINGE PIVOT LINKS W/SQ X 13/32" END P/N 7624
- (2) HINGE PIVOT LINKS W/SQ X 17/32" END P/N 7625
- (2) 3 HOLE ANGLE BRACKET P/N 10313
- (2) 2 HOLE ANGLE BRACKET P/N 10318
- (4) RUBBER WASHER 3/8" P/N 3559
- (4) STRUT NUT 3/8-16 P/N 3561
- (6) RUBBER WASHER 1/2" P/N 3579
- (6) FLAT WASHER 1/2" P/N 3634
- (2) SHOULDER BOLT 3/8-16 X 1/2"DIA X 5/8 LG P/N 10317
- (2) SHOULDER BOLT 3/8-16 X 1/2"DIA X 3/8 LG P/N 4018
- (4) CARRIAGE BOLT 3/8-16 X 1-1/2" P/N 4019
- (2) WING NUT 3/8-16 P/N 4020
- (2) LOCK NUT NYLON INSERT 3/8-16 P/N 4021
- (4) HEX HEAD BOLT 3/8-16 X 1-1/2" P/N 4022
- (8) FLAT WASHER 3/8 P/N 4023

Parts:

Parts are shown below in their basic orientation (for clarity the fixture is not shown).

EXPLODED  
VIEW

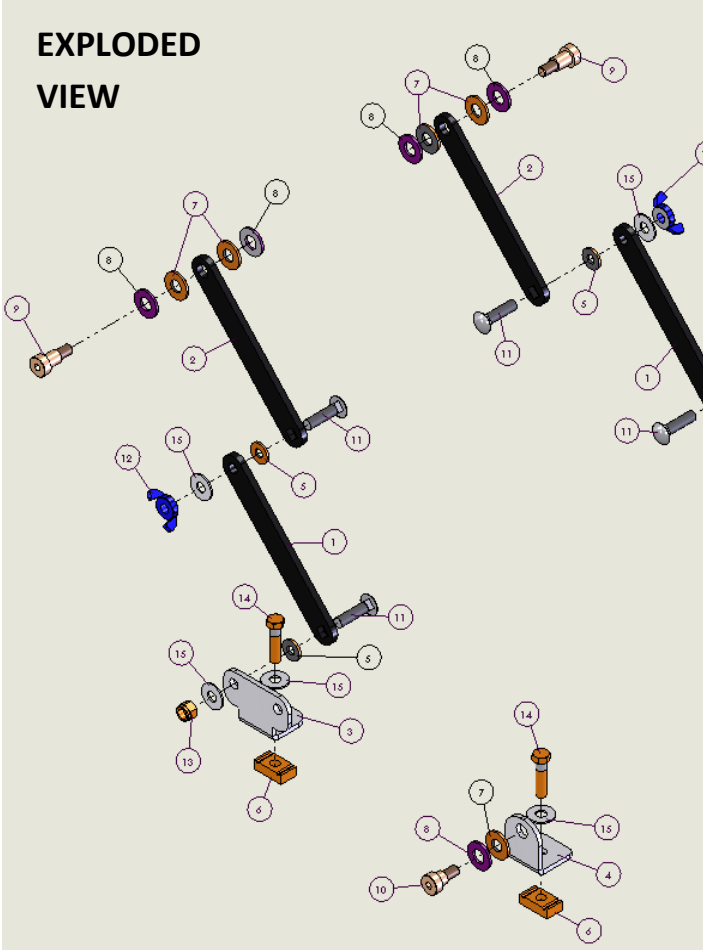

ITEM NO.	DESCRIPTION	FINISHED QTY.	RAW QTY.	PART NUMBER
1	HINGE PIVOT W/5 Q. X 13/32" END 1/4" A36 HRS	2		7624
2	HINGE PIVOT W/3 Q. X 17/32" END 1/4" A36 HRS	2		7625
3	ANGLE SHOLE A36 STEEL 2"x1-3/4"x3/16"	2		10313
4	ANGLE SHOLE 2"x1-3/4"x3/16" A36 HRS	2		10318
5	WASHER RUBBER 3/8"x.093THK EPDM	4		3559
6	STRUT NUT NO SPRING 3/8-16	4		3561
7	WASHER RUBBER 1/2"x.093THK EPDM	6		3579
8	FLAT WASHER 1/2" SAE ZINC	6		3634
9	BOLT SHOULDER 3/8-16 X1/2 DIA 5/8 LONG	2		10317
10	BOLT SHOULDER 3/8-16 X1/2 DIA 3/8 LONG	2		4018
11	BOLT CARRIAGE 3/8-16 X1 1/2	4		4019
12	WIN G NUT 3/8-16 ZINC PLATED	2		4020
13	LOCK NUT NYLON INSERT 3/8-16 UNC	2		4021
14	HMCS 3/8-16 X1 1/2 ZINC PLATED	4		4022
15	3/8 FLAT WASHER ZINC PLATED	8		4023

PARTS SHOWN PARTIALLY ASSEMBLED

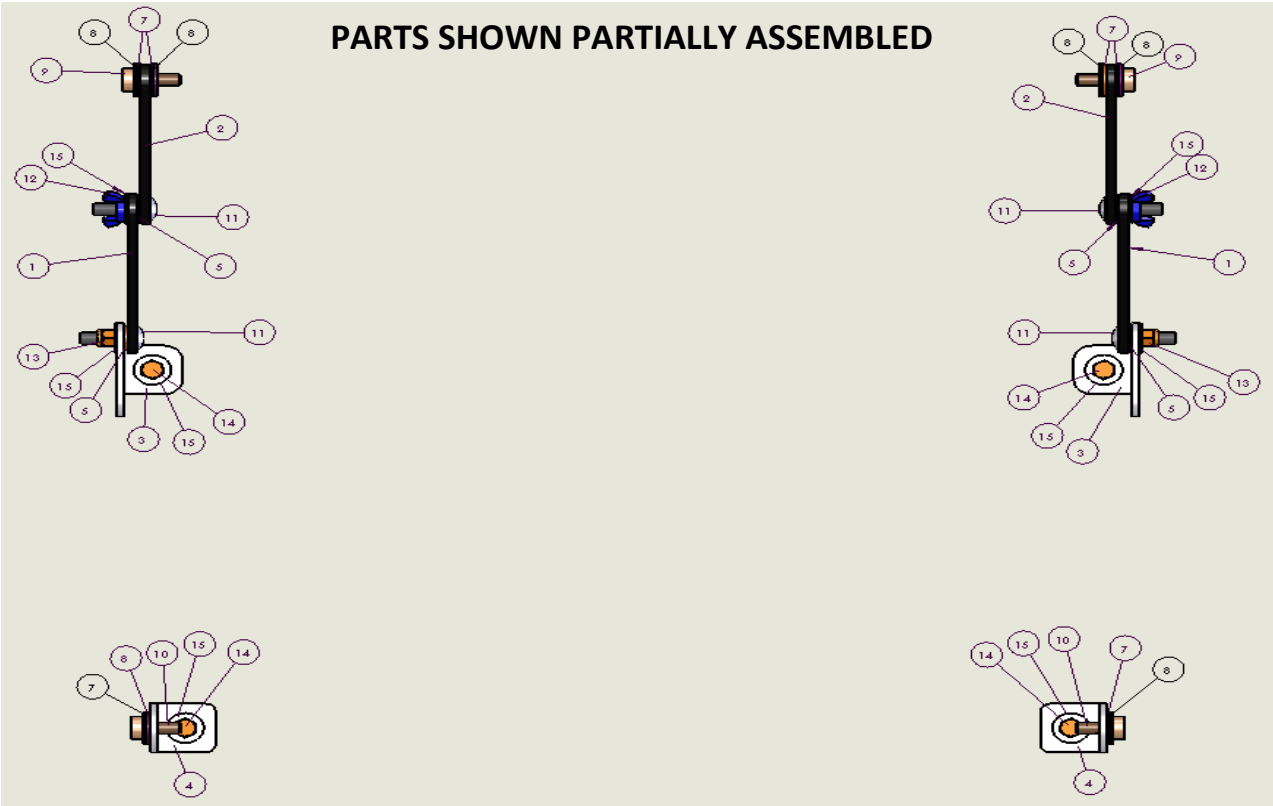

## **Mounting:**

This mounting kit is intended to allow for the angle of the fixture to be adjusted so that it can be aimed at the object inspected. The kit is intended to be vertically mounted on the wall or overhead.

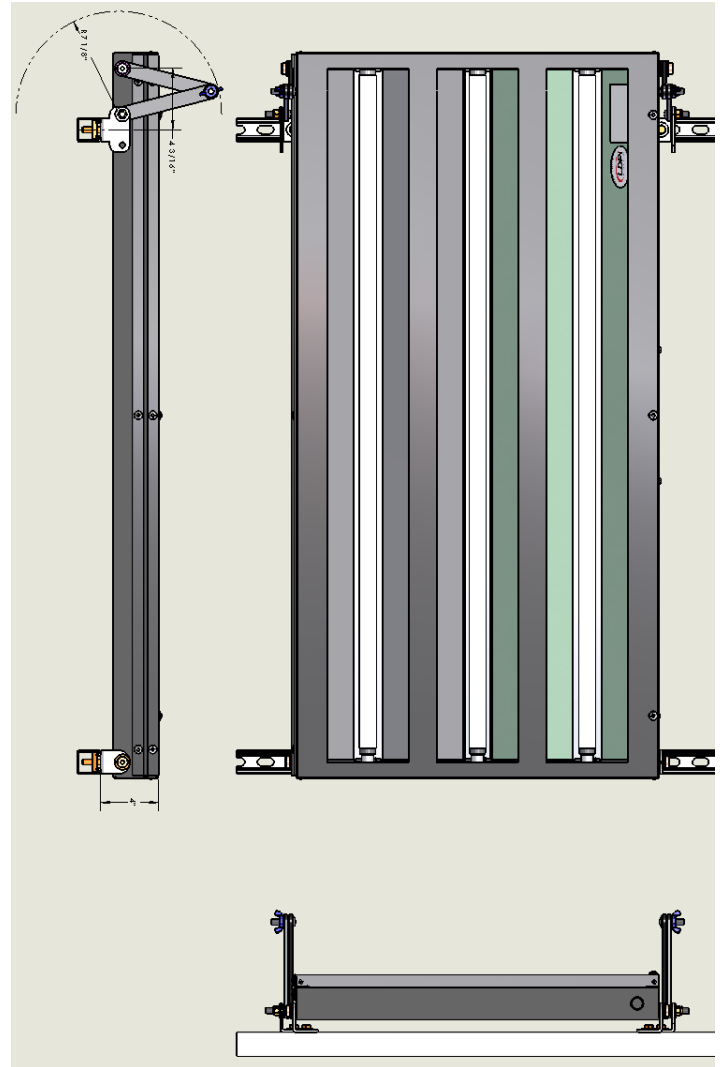
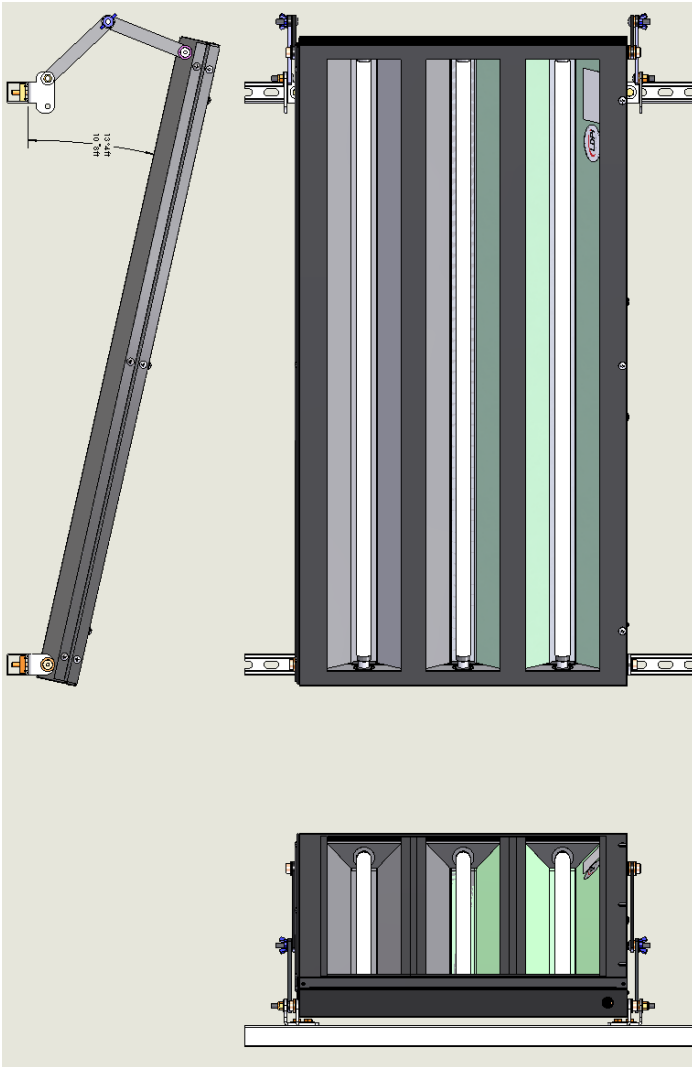



ITEM NO.	DESCRIPTION	QTY.	PART NUMBER
1	HINGE PIVOT W/5 Q X 13/32" END 1/4" A36 HRS	2	7624
2	HINGE PIVOT W/5 Q X 17/32" END 1/4" A36 HRS	2	7625
3	ANGLE SHOLE A36 STEEL 2" X 1-3/4" X 3/16"	2	10313
4	ANGLE 2HOLE 2" X 1-3/4" X 3/16" A36 HRS	2	10318
5	WASHER RUBBER 3/8" X .093 THK EPDM	4	3559
6	STRUT NUT HO SPRING 3/8-16	4	3561
7	WASHER RUBBER 1/2" X .093THK EPDM	6	3579
8	FLAT WASHER 1/2" 5 AE ZINC	6	3634
9	BOLT SHOULDER 3/8-16 X 1 1/2 DIA X 5/8 LONG	2	10317
10	BOLT SHOULDER 3/8-16 X 1 1/2 DIA X 3/8 LONG	2	4018
11	BOLT CARRIAGE 3/8-16 X 1 1/2	4	4019
12	WING NUT 3/8-16 ZINC PLATED	2	4020
13	LOCK NUT NYLON INSERT 3/8-16 UNC	2	4021
14	HHCS 3/8-16 X 1 1/2 ZINC PLATED	4	4022
15	3/8 FLAT WASHER ZINC PLATED	8	4023

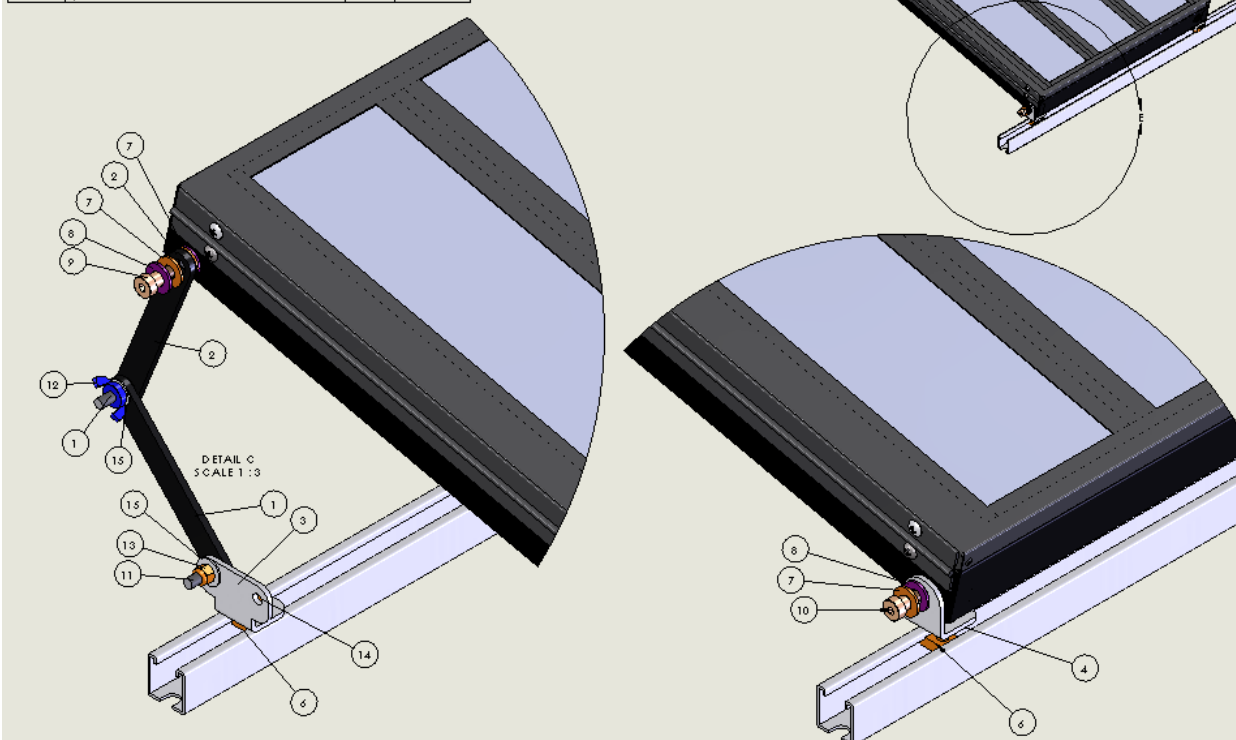

## Installation:

1. Measure the fixture and determine the position of the mounting brackets on the structure.
2. The main hinge assembly was already preassembled at the factory.
3. Mount the brackets and hinge assemblies to the uni-strut as shown using the 3/8-16 x 1-1/2" hex head bolts, 3/8 washers, and strut nuts. Tighten the bolt until it bottoms out on the bracket while leaving it loose enough to still allow the bracket to slide on the uni-strut. You will come back later and tighten these bolts once the fixture is in place.
4. While fully supporting the light fixture attach it to the lower mounting brackets by aligning the threaded attachment holes on the side of the fixture with holes in the brackets and inserting the Shoulder Bolt 3/8-16 X 1/2" DIA X 3/8 LG through the 1/2" Flat Washer, 1/2" Rubber Washer and 2 Hole Bracket and into the fixture attachment holes. Fully tighten the bolts.
5. While fully supporting the light fixture attach it to the hinge assembly by aligning the threaded attachment holes on the side of the fixture with holes in the hinge pivot links and inserting the Shoulder Bolt 3/8-16 X 1/2" DIA X 5/8 LG through the 1/2" Flat Washer, 1/2" Rubber Washer and 2 Hole Bracket and into the fixture attachment holes. Fully tighten the bolts.
6. Once the fixture is attached to the brackets go back and fully tighten the bolts that are holding the brackets to the structure.
7. Angle adjustment can be made by loosening the wing nut and adjusting the angle of the fixture as needed. Once the desired angle is reached fully tighten the wing nut to hold the position.



# INSTALLATION INSTRUCTIONS

## INSPECTION FIXTURE STATIONARY MOUNTING KIT P/N 10315

FOR USE WITH LEINS3, INS3, 39042LINS AND 39082LINS SERIES FIXTURES

### WARNING!

1. THESE INSTALLATION INSTRUCTIONS COVER THE ASSEMBLY OF THE MOUNTING KIT ONLY. FOR INSTALLATION AND WIRING OF THE LIGHT FIXTURE PLEASE REFER TO THE INSTALLATION INSTRUCTIONS FOR THAT PARTICULAR LIGHT FIXTURE.
2. IT IS THE CUSTOMERS RESPONSIBILITY TO INSURE THAT THE STRUCTURE THIS MOUNTING KIT IS ATTACHED TO IS CAPABLE OF SUPPORTING THE WEIGHT OF THE LIGHT FIXTURE THAT IT IS BEING USED TO MOUNT. CONSULT THE LDPI SPECIFICATION SHEET FOR THE WEIGHT OF YOUR PARTICULAR FIXTURE.
3. THESE INSTALLATION INSTRUCTIONS SHOW HOW THE MOUNTING KIT CAN BE ATTACHED TO A UNI-STRUT STRUCTURE. IF THE KIT IS MOUNTED TO A DIFFERENT TYPE OF STRUCTURE OR SURFACE IT IS THE CUSTOMERS RESPONSIBILITY TO SELECT AND USE THE APPROPRIATE TYPE OF MOUNTING HARDWARE FOR THEIR APPLICATION.
4. THIS FIXTURE SHOULD BE INSTALLED BY QUALIFIED TECHNICIANS IN STRICT ACCORDANCE WITH THE NATIONAL ELECTRICAL CODE AND ANY LOCAL REQUIREMENTS.

### EACH KIT INCLUDES:

- (4) ANGLE BRACKETS P/N 10385
- (4) STRUT NUTS 3/8-16 P/N 3561
- (4) HEX HEAD BOLTS 3/8-16 X 1-1/2" LONG P/N 4022
- (4) FLAT WASHERS 3/8 P/N 4023
- (4) HEX HEAD BOLTS 3/8-16 X 1" LONG P/N 4441

**Parts:**

Parts are shown below in their basic orientation for the two different mounting options (for clarity the fixture is not shown).

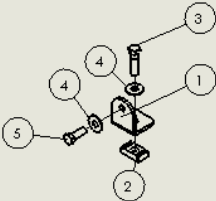

**MOUNTING  
OPTION 1**

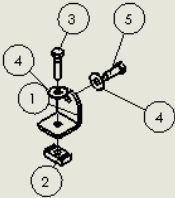

**MOUNTING  
OPTION 2**

ITEM NO.	DESCRIPTION	FINISHED QTY.	RAW QTY.	PART NUMBER
1	ANGLE 2HOLE A36 Steel 2" x 1-3/4" x 3/16"	4		10385
2	STRUT NUT NO SPRING 3/8-16	4		3561
3	HHCS 3/8-16 X 1 1/2 ZINC PLATED	4		4022
4	3/8 FLAT WASHER ZINC PLATED	8		4023
5	HHCS 3/8-16 X 1 ZINC-PLATED	4		4441

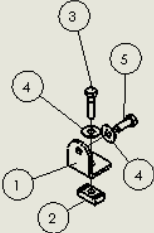

## Mounting Options:

### Mounting Option 1:

This mounting option has the structure side of the brackets hidden behind the fixture and requires access from the top and bottom of the fixture for final tightening of the struture bolts. This method allows the fixtures to be closer together.

### Mounting Option 2:

This mounting option has the structure side of the brackets exposed on the side of the fixture and allows easier access to the structure fasteners

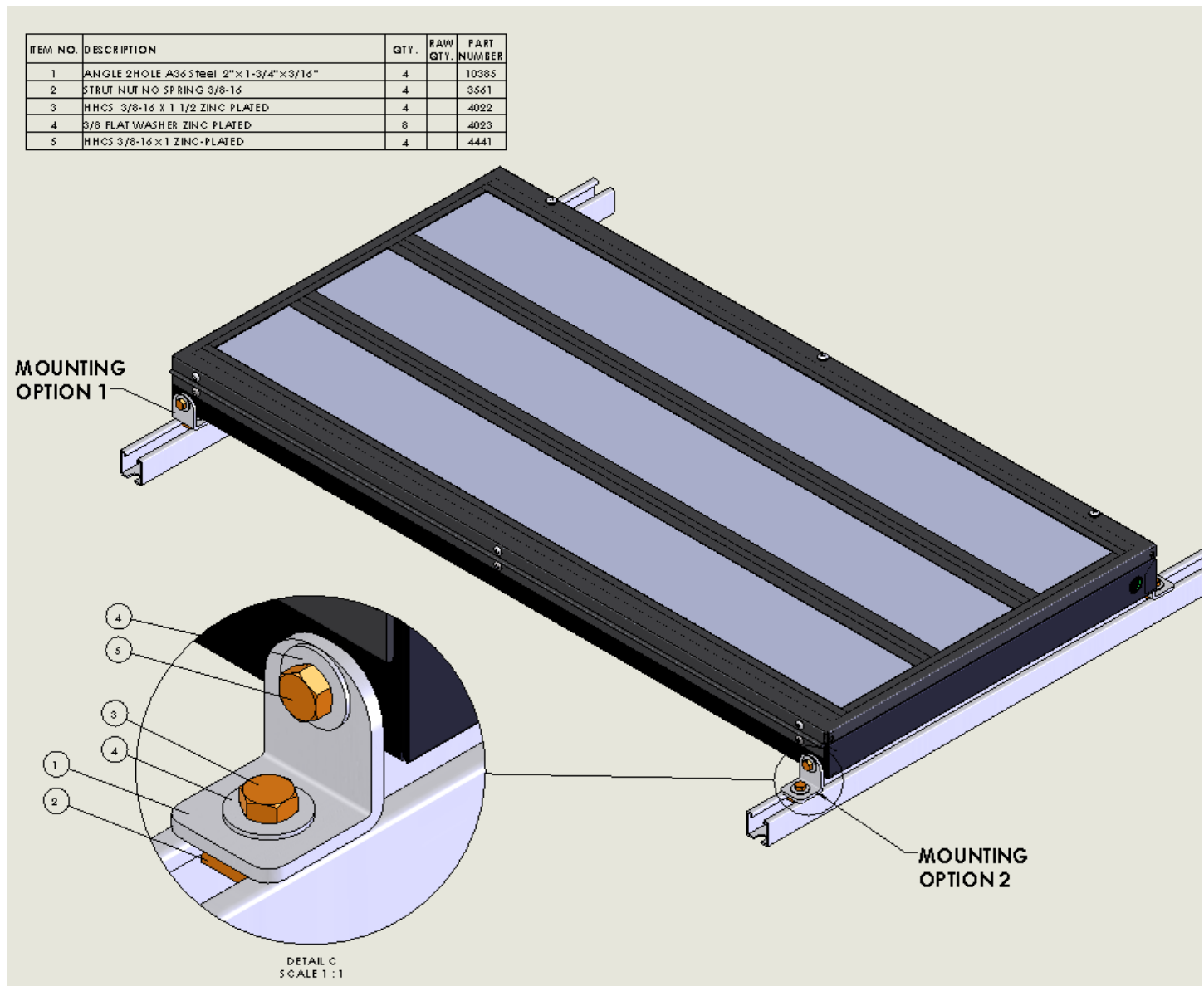

## Installation:

1. Select your desired mounting option from above. Both mounting methods are the same with the exception of which way the bracket is facing.

2. Measure the fixture and determine the position of the mounting brackets.
3. Mount the brackets to the uni-strut as shown with the rounded portion of the bracket to be used for the fixture using the 3/8-16 x 1-1/2" hex head bolt, 3/8 washer, and strut nut. Tighten the bolt until it bottoms out on the bracket while leaving it loose enough to still allow the bracket to slide on the uni-strut. You will come back later and tighten these bolts once the fixture is in place.
4. While fully supporting the light fixture attach it to the brackets by aligning the threaded attachment holes on the side of the fixture with holes in the brackets and inserting the 3/8-16 x 1" hex head bolt through the 3/8 washer and bracket and into the fixture attachment holes. Fully tighten the bolts.
5. Once the fixture is attached to the brackets go back and fully tighten the bolts that are holding the brackets to the structure.



# INSTALLATION INSTRUCTIONS

## INSPECTION FIXTURE FLUSH STATIONARY MOUNT KIT P/N 10387

FOR USE WITH LEINS3, INS3, 39042LINS AND 39082LINS SERIES FIXTURES

### WARNING!

1. THESE INSTALLATION INSTRUCTIONS COVER THE ASSEMBLY OF THE MOUNTING KIT ONLY. FOR INSTALLATION AND WIRING OF THE LIGHT FIXTURE PLEASE REFER TO THE INSTALLATION INSTRUCTIONS FOR THAT PARTICULAR LIGHT FIXTURE.
2. IT IS THE CUSTOMERS RESPONSIBILITY TO INSURE THAT THE STRUCTURE THIS MOUNTING KIT IS ATTACHED TO IS CAPABLE OF SUPPORTING THE WEIGHT OF THE LIGHT FIXTURE THAT IT IS BEING USED TO MOUNT. CONSULT THE LDPI SPECIFICATION SHEET FOR THE WEIGHT OF YOUR PARTICULAR FIXTURE.
3. THESE INSTALLATION INSTRUCTIONS SHOW HOW THE MOUNTING KIT CAN BE ATTACHED TO A UNI-STRUT STRUCTURE. IF THE KIT IS MOUNTED TO A DIFFERENT TYPE OF STRUCTURE OR SURFACE IT IS THE CUSTOMERS RESPONSIBILITY TO SELECT AND USE THE APPROPRIATE TYPE OF MOUNTING HARDWARE FOR THEIR APPLICATION.
4. THIS FIXTURE SHOULD BE INSTALLED BY QUALIFIED TECHNICIANS IN STRICT ACCORDANCE WITH THE NATIONAL ELECTRICAL CODE AND ANY LOCAL REQUIREMENTS.

### EACH KIT INCLUDES:

- (4) ANGLE BRACKETS P/N 10386
- (4) STRUT NUTS 3/8-16 P/N 3561
- (4) HEX HEAD BOLTS 3/8-16 X 1-1/2" LONG P/N 4022
- (4) FLAT WASHERS 3/8 P/N 4023
- (4) HEX HEAD BOLTS 3/8-16 X 1" LONG P/N 4441

**Parts:**

Parts are shown below in their basic orientation (for clarity the fixture is not shown).

ITEM NO.	DESCRIPTION	FINISHED QTY.	RAW QTY.	PART NUMBER
1	ANGLE 2 HOLE 1-1/4" x 2-1/4"	4		10286
2	STRUCT HLT HO SPRING 3/8-16	4		2561
3	HHCS 3/8-16 X 1 1/2 ZINC PLATED	4		4022
4	3/8 FLAT WASHER ZINC PLATED	8		4022
5	HHCS 3/8-16 X 1 ZINC PLATED	4		4441

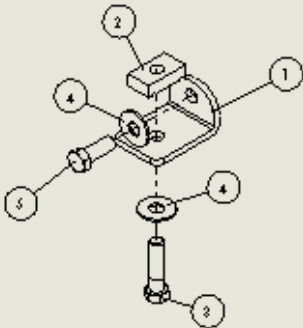
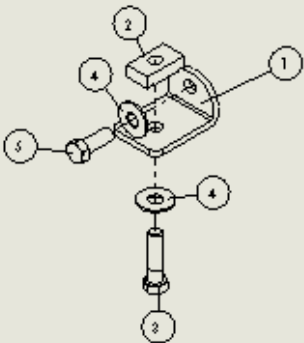
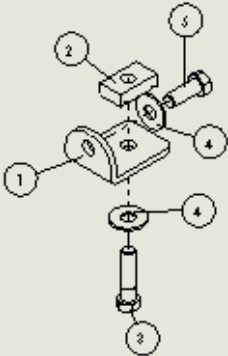
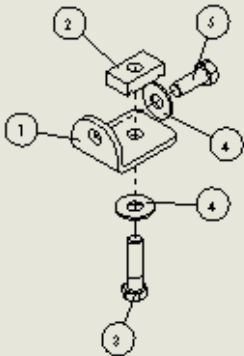

## Mounting:

This mounting kit is intended to allow for a lower profile fit between to structural members or up against a structure or surface.

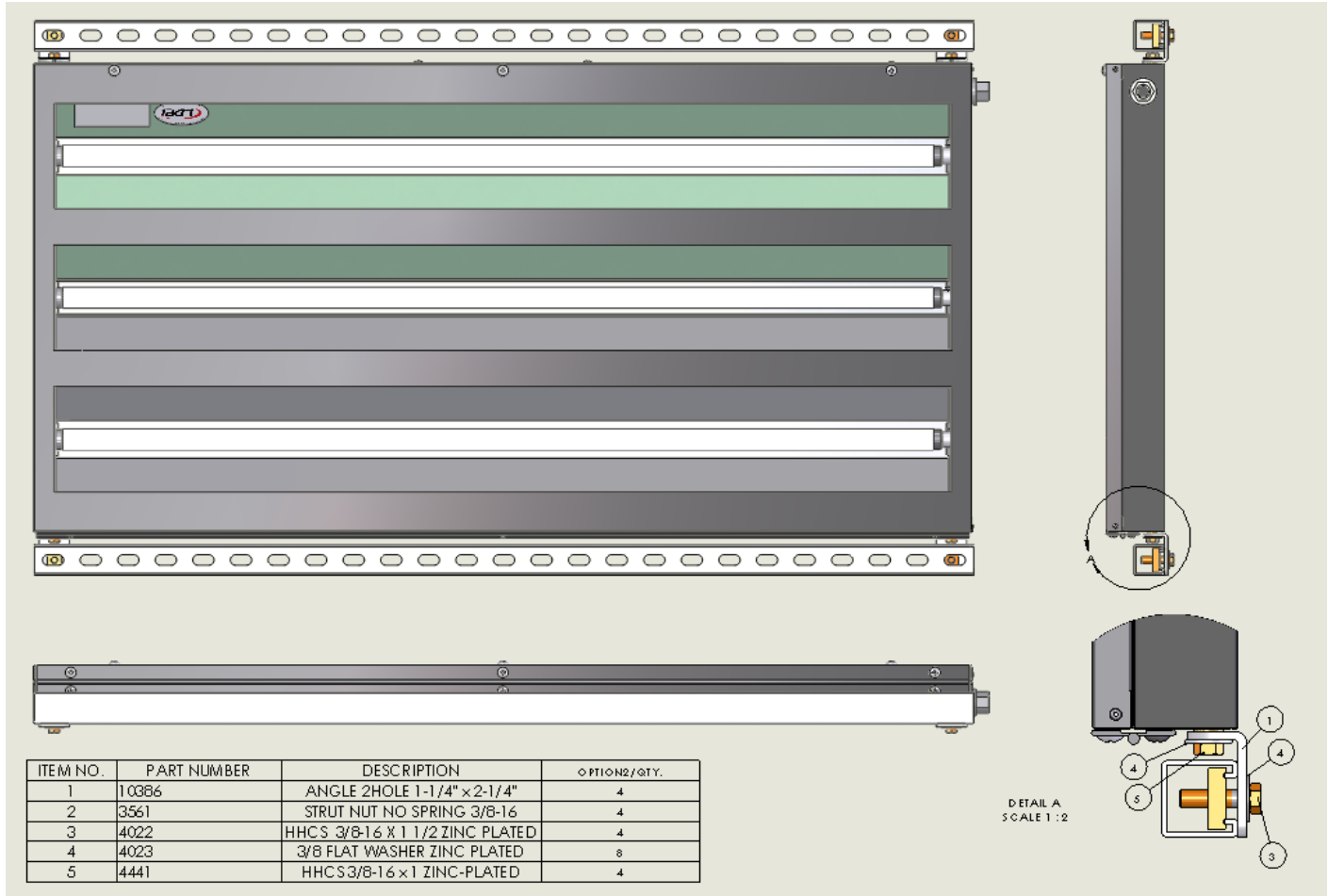

## Installation:

1. Measure the fixture and determine the position of the mounting brackets on the structure.
2. Mount the brackets to the uni-strut as shown with the rounded portion of the bracket to be used for the fixture using the 3/8-16 x 1-1/2" hex head bolt, 3/8 washer, and strut nut. Tighten the bolt until it bottoms out on the bracket while leaving it loose enough to still allow the bracket to slide on the uni-strut. You will come back later and tighten these bolts once the fixture is in place.
3. While fully supporting the light fixture attach it to the brackets by aligning the threaded attachment holes on the side of the fixture with holes in the brackets and inserting the 3/8-16 x 1" hex head bolt through the 3/8 washer and bracket and into the fixture attachment holes. Fully tighten the bolts.
4. Once the fixture is attached to the brackets go back and fully tighten the bolts that are holding the brackets to the structure.





# INSTALLATION INSTRUCTIONS

## INSPECTION FIXTURE 3-ROW CABLE/CHAIN HANG BRACKET KIT P/N 15990 FOR USE WITH LEINS3 SERIES FIXTURES

### WARNING!

1. THESE INSTALLATION INSTRUCTIONS COVER THE ASSEMBLY OF THE MOUNTING KIT ONLY. FOR INSTALLATION AND WIRING OF THE LIGHT FIXTURE PLEASE REFER TO THE INSTALLATION INSTRUCTIONS FOR THAT PARTICULAR LIGHT FIXTURE.
2. IT IS THE CUSTOMERS RESPONSIBILITY TO SUPPLY THE CABLE OR CHAIN TO USE WITH THIS BRACKET KIT AND INSURE THAT IT AND THE STRUCTURE IT IS HUNG FROM ARE CAPABLE OF SUPPORTING THE WEIGHT OF THE LIGHT FIXTURE THAT IT IS BEING USED TO SUSPEND. CONSULT THE LDPI SPECIFICATION SHEET FOR THE WEIGHT OF YOUR PARTICULAR FIXTURE.
3. THIS FIXTURE SHOULD BE INSTALLED BY QUALIFIED TECHNICIANS IN STRICT ACCORDANCE WITH THE NATIONAL ELECTRICAL CODE AND ANY LOCAL REQUIREMENTS.

### EACH KIT INCLUDES:

- (2) LEIN3 3-ROW CABLE/CHAIN HANG BRACKETS P/N 16061
- (4) FLAT WASHERS 3/8 P/N 4023
- (4) HEX HEAD BOLTS 3/8-16 X 1" LONG P/N 4441

## Mounting:

This mounting kit is intended to make it easier to cable or chain hang the fixture by offering a safe and rigid attachment point for the chosen means of suspending the fixture. This kit does not include cable or chain since the length and style preferred can vary from customer to customer. It is the customers responsibility to size the cable or chain to support the appropriate load.

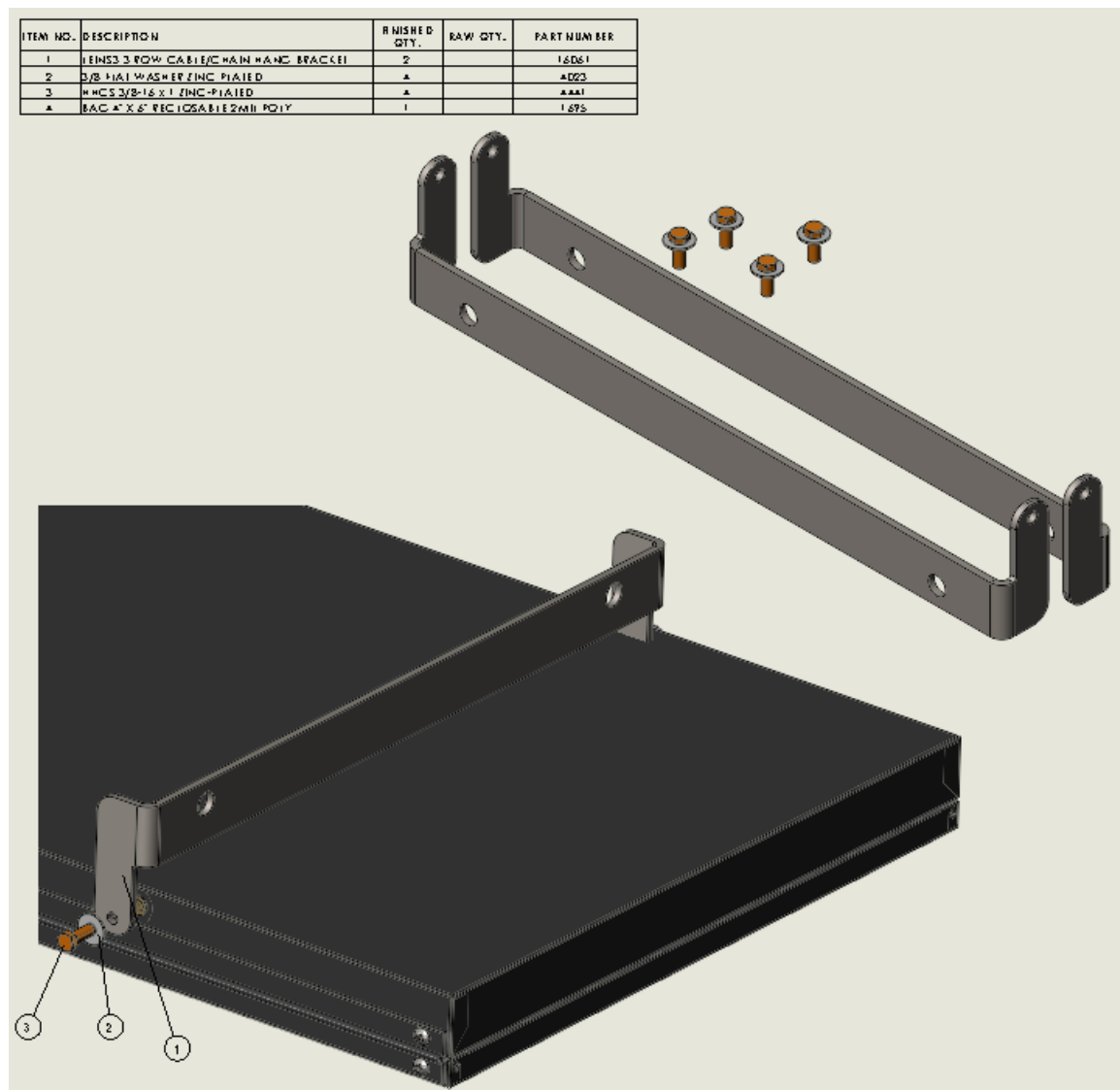

## Installation:

1. Mount the brackets to the fixture as shown and fully tighten the attachment bolts.
2. Suspend the fixture from the holes at the top of the bracket.