



INSTALLATION, OPERATION AND MAINTENANCE INSTRUCTIONS

PATCH PANEL (RETRO-FIT) KIT FOR LE485E LED LIGHT FIXTURE SPRAY / PAINT BOOTH & CLEAN ROOM APPLICATIONS

WARNING!

1. TO PREVENT THE RISK OF ELECTRICAL SHOCK DEACTIVATE/DISCONNECT THE POWER SUPPLY BEFORE REMOVING ORIGINAL FIXTURE AND INSTALLING NEW KIT.
2. THE DRIVER IN THIS FIXTURE IS DESIGNED TO OPERATE ON GROUNDED NEUTRAL SYSTEMS ONLY.
3. THIS FIXTURE SHOULD BE INSTALLED BY QUALIFIED TECHNICIANS IN STRICT ACCORDANCE WITH THE NATIONAL ELECTRICAL CODE AND ANY LOCAL REQUIREMENTS.

PAINT SPRAY BOOTH APPLICATIONS

The fixture and retrofit panel should be sealed in such a way that only the face of the light fixture is exposed to the paint environment and the sides and rear are located in the Class I Division 2 environment.

DISCLAIMER

This is a Retro-Fit Kit! Customer may be required to use additional fasteners for install to help seal kit and ensure that ratings remain intact.

- If fixture has a special suffix (Sxxx) at the end of nomenclature, please consult factory for cutout and panel sizes.
- No additional cutting or drilling will be required if replacing any of the following fixtures 390260 or 390261.
- Fixture and patch panel must be caulked after install to guarantee a seal in the booth wall.

OPERATIONAL DATA

Operate this fixture at its rated voltage. See fixture label for data. Do not install where the marked operating temperature exceeds the ignition temperature of the hazardous atmospheres.

INSTALLATION

Each kit includes:

- Patch panel for specific light fixture
- Mounting brackets (2) with 1/4"-20 rivet nuts (2 EA)
- 1/4"-20 Clip-on nuts (8) for installing LE485E to patch panel
- Bolts (12) for installing LE485E

Customer requirements:

- Drill (5/16" Diameter)
- Fasteners
- Caulk (approved for use in booth applications)

Before starting, make sure power is disconnected!

Step 1

Remove fasteners and existing light fixture.

- Remove all fasteners from existing light fixture. **Keep fasteners**, they will be used later.
- Remove light fixture from booth wall.

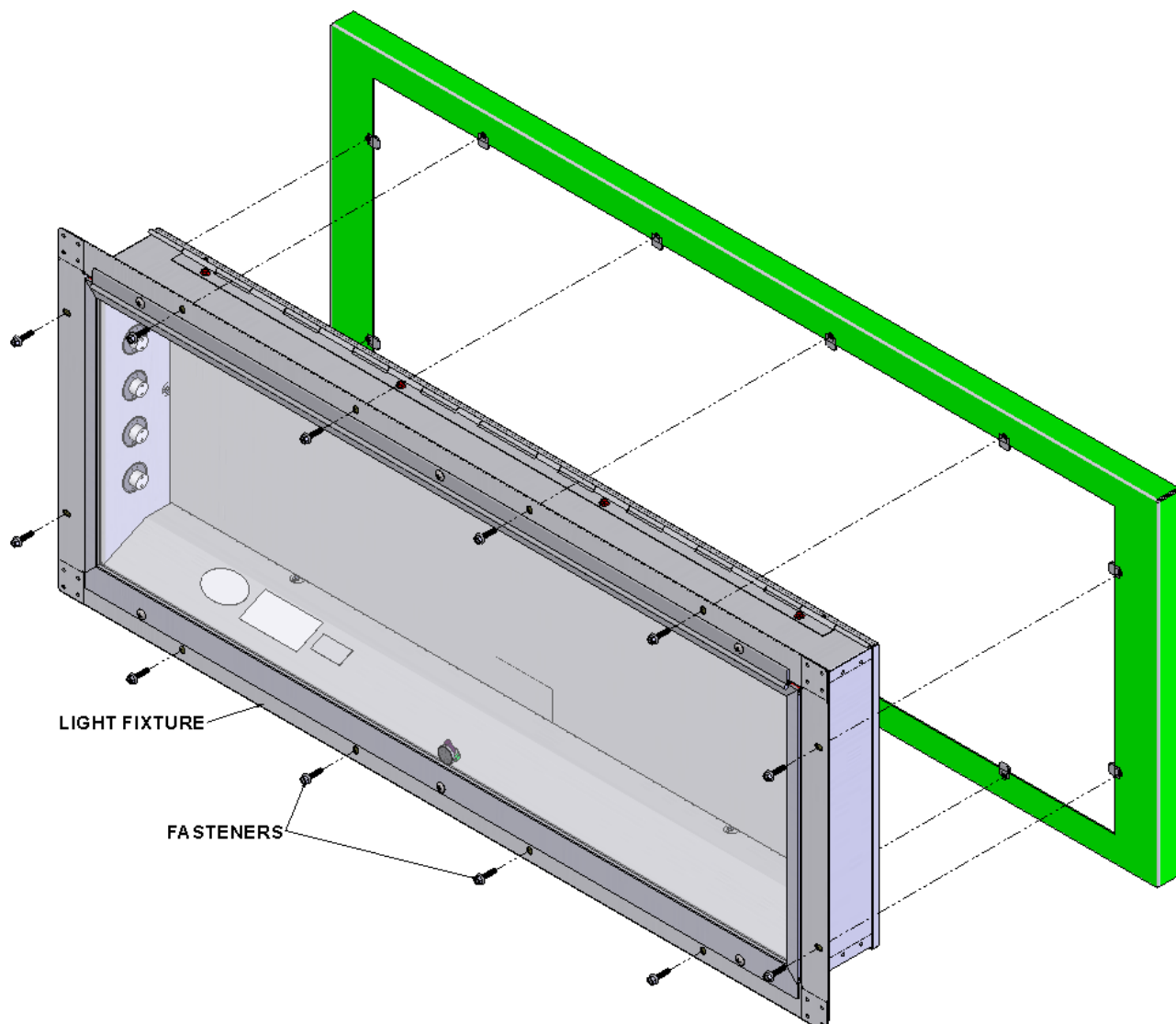

Step 2

Install patch panel

- Using fasteners from original light fixture, lightly secure patch panel to booth wall with 8 screws as shown below. Leave screws slightly loose so that caulk can be applied between patch panel and booth wall, see step 3.

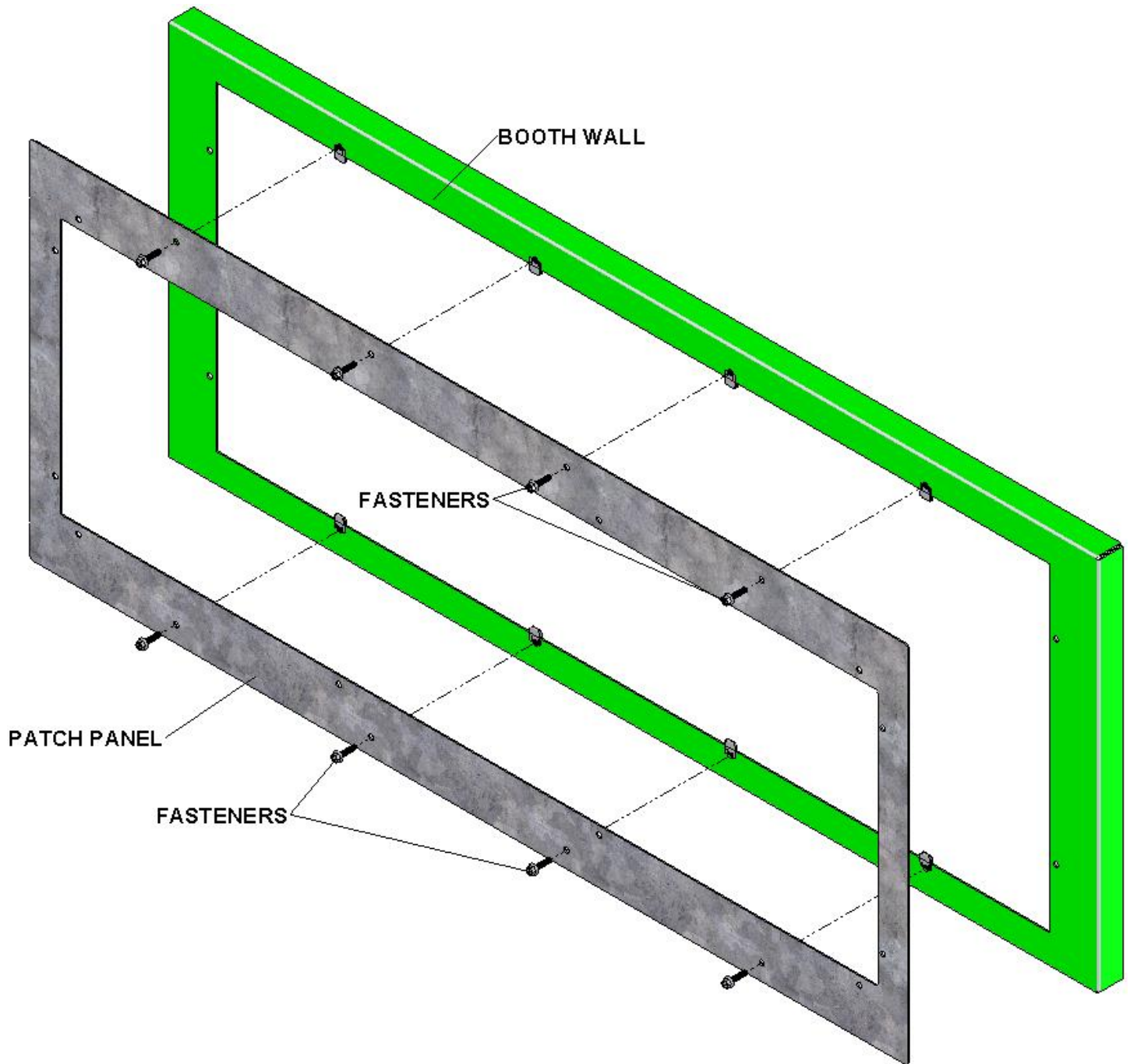

Step 3

Caulk and secure panel

- Make sure fasteners are not completely tight on patch panel.
- Caulk around all edges of patch panel so that caulk is between panel and booth wall, as shown below.
- Tighten fasteners to secure panel.

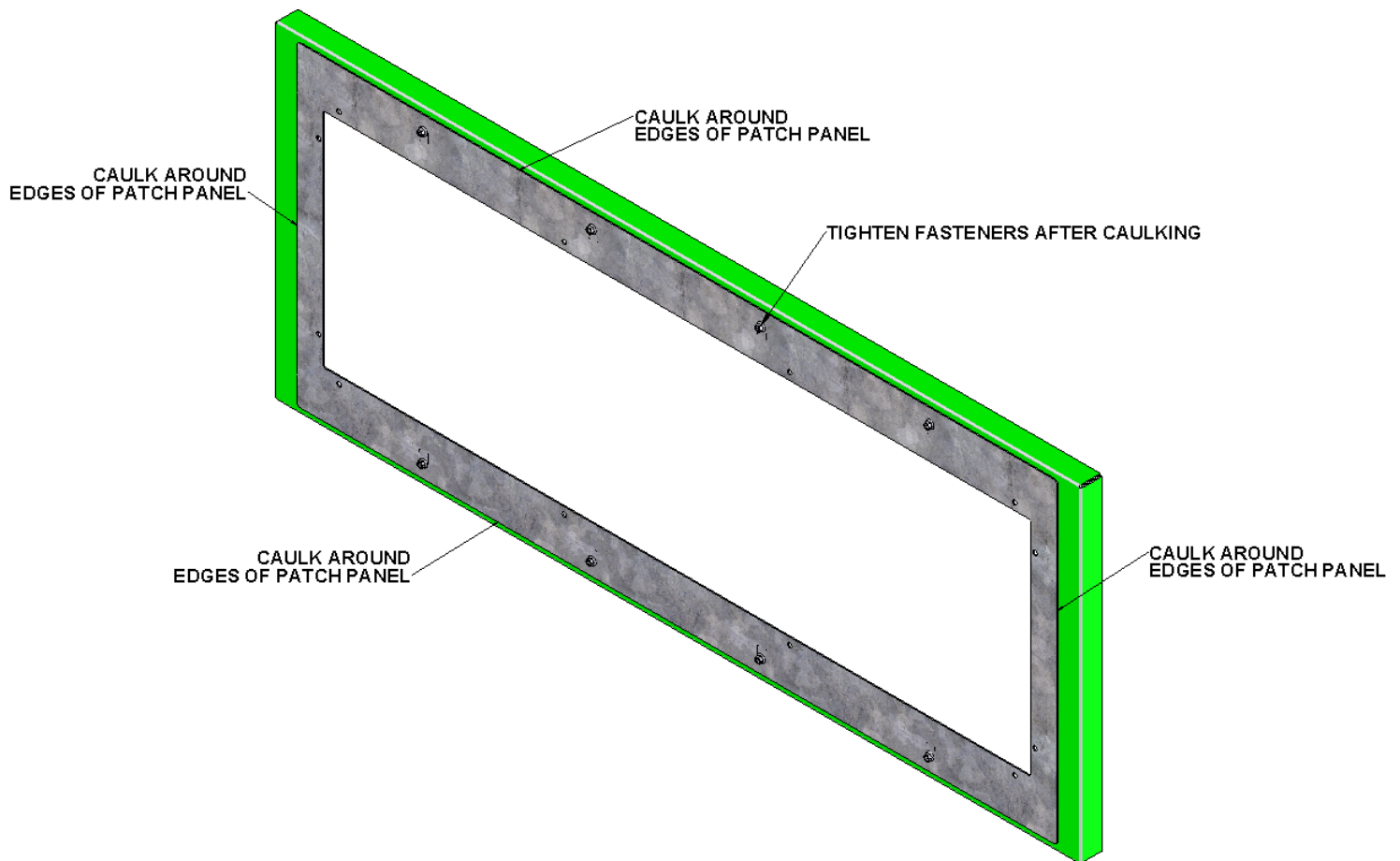

Step 4

Install clip-on nuts

- Install clip-on nuts over panel in LE485E cutout so that they cover the holes, make sure clip-on nuts are secured in place.

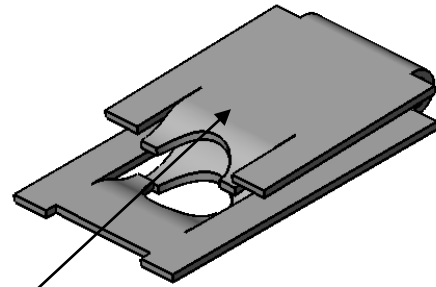

Short side of clip-on nut to face inside of booth

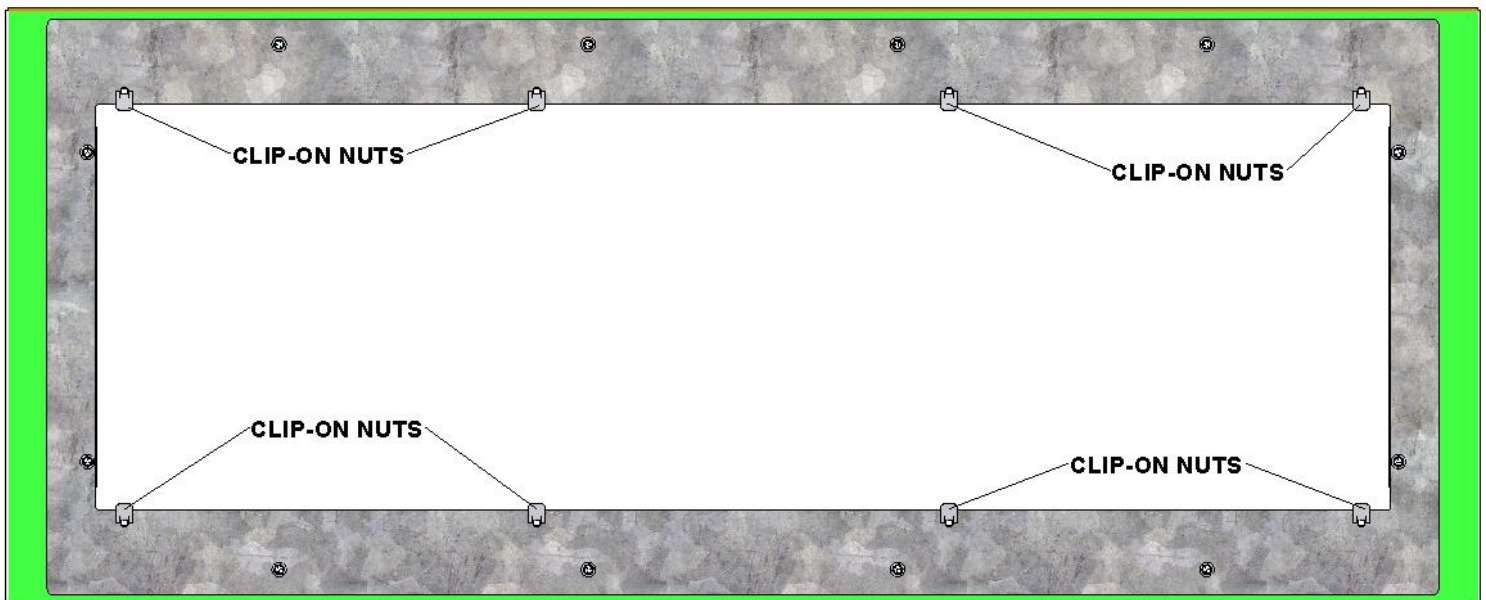

Step 5

Install LE485E fixture

- Connect power to fixture, must be connected by a qualified individual.
- Take all necessary safety precautions when connecting power to fixture.
- Fixture must be installed using conduit
- Using the bolts provided, install the fixture into the opening using mounting brackets and clip-on nuts that were installed in previous step.
- Take care not to smear or contact the caulk during this step.

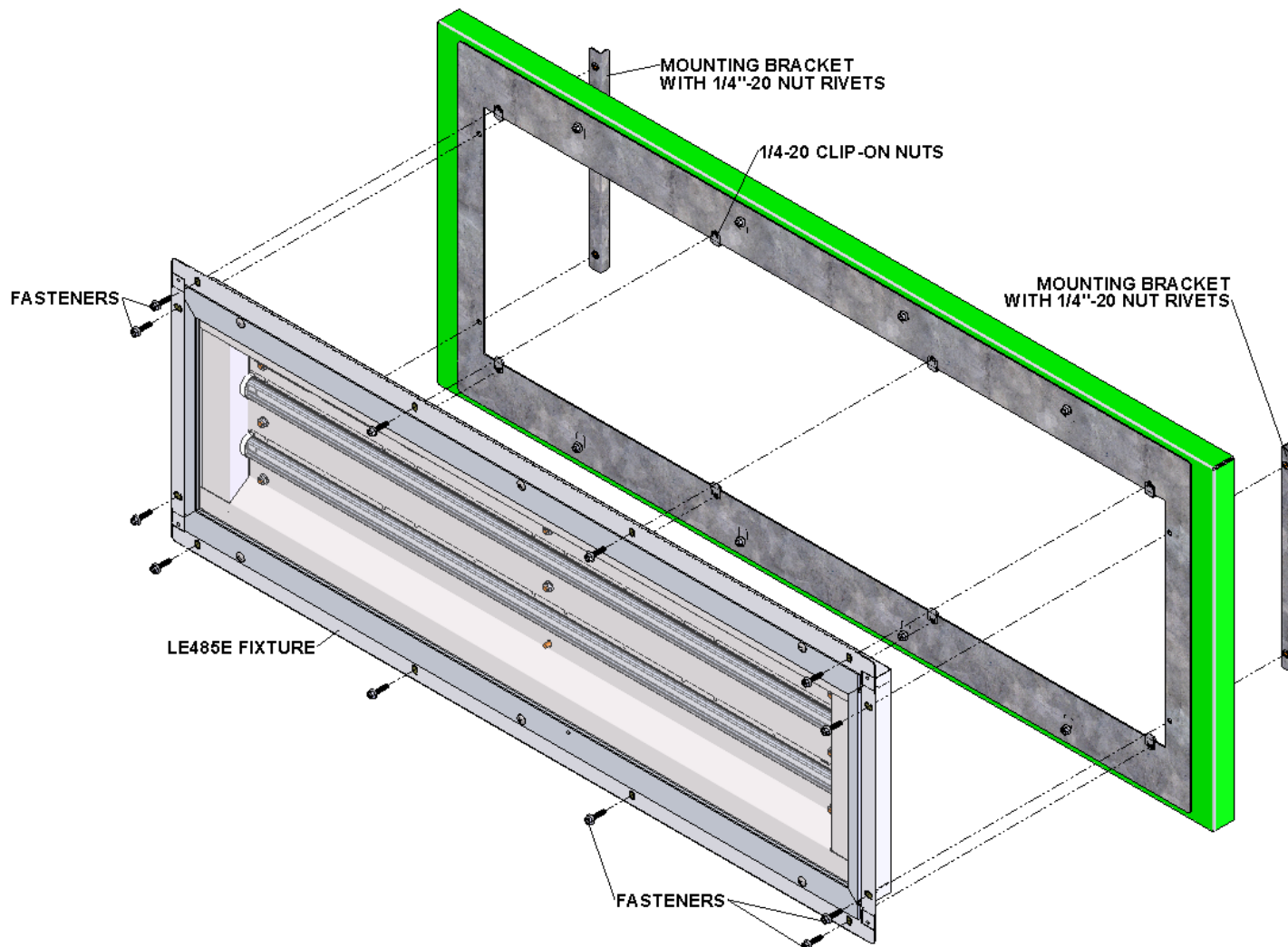

Step 6

Caulk fixture and panel

- Caulk around edges of fixture
- Caulk around edges of patch panel if any caulking was damaged while installing LE485E fixture.

